



Smith Biomed
97 Gill Street New Plymouth
E: info@smithbiomed.com

smithbiomed.com

Ferritin Iron Deficiency At Home Testing Kit

Get on top of iron deficiency with our safe, accurate and affordable at home testing kits.

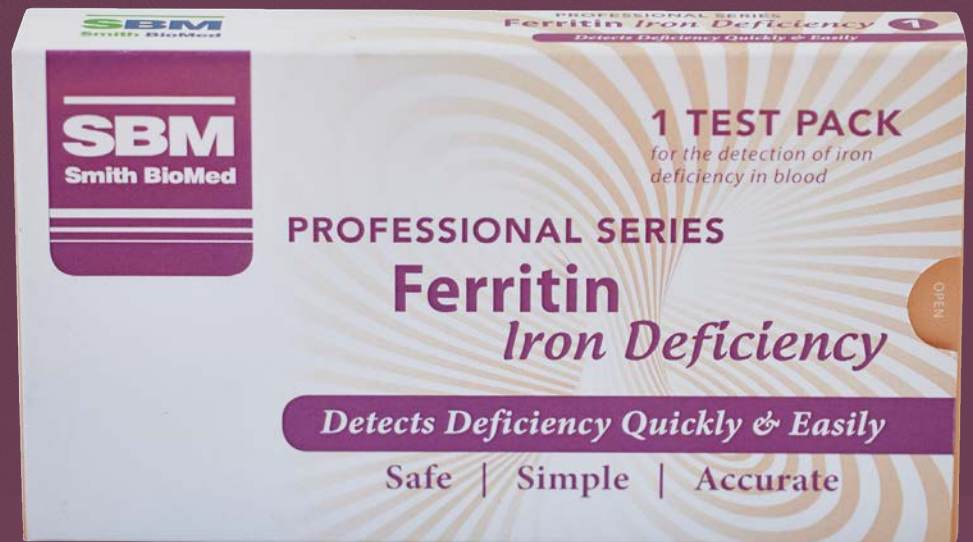

Affordable: Our home ferritin test is the most affordable on the market.



Quick & Accurate: Skip lines, get precise results in minutes with our easy-to-use tests.



Accessible: Available at Chemist Warehouse and local chemists - iron level testing made easy.

Procedure – how to do the test

Keep out of reach of children

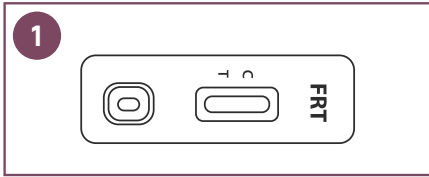

Wash your hands with soap and rinse with clear warm water. Open the foil pouch and get out the Cassette-place on a flat surface.

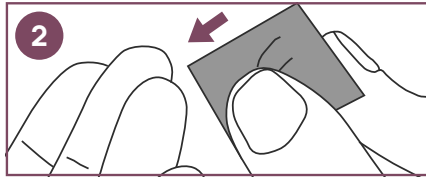

Use the provided alcohol pad to clean the fingertip of the middle or ring finger as the puncture site.

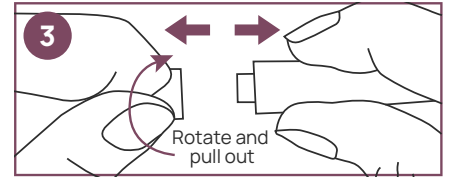

Carefully twist and pull off and dispose the round cap of the lancet.



Press the lancet, against your fingertip on the side from where the cap was extracted. This will allow the lancet to pierce the skin. The tip of the lancet retracts automatically and safely after use.

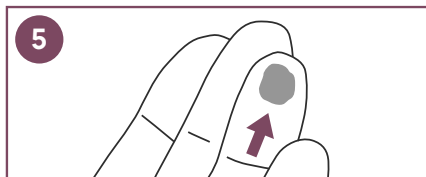

Keeping your hand down massage the end of the finger to obtain a blood drop.

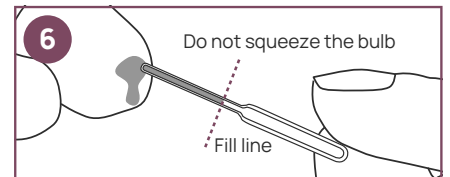

Place the capillary dropper in contact with the blood without squeezing the bulb. Let the blood flow into the dropper until it reaches the indicated line. Massage your finger if more blood is needed to reach the line.

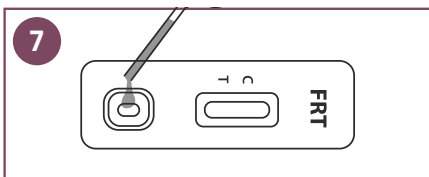

Put the blood collected into the sample well marked 'S' of the cassette, by **squeezing the dropper bulb**.

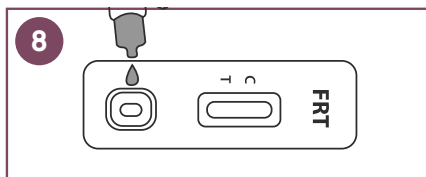

Wait for all the blood to be in the well then unscrew the cap of the buffer bottle and add **1 drop of buffer** into the same sample well of the cassette.

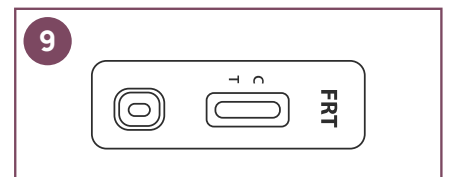

Wait for the coloured line(s) to appear. **Read results at 5 minutes**. Do not interpret the result after 10 minutes.

Interpretation of results

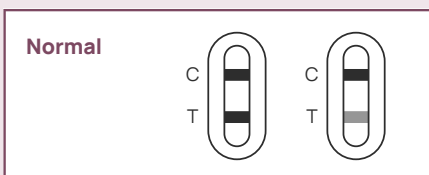

Two coloured lines appear. Both the **T** (Test) and **C** (Control) lines appear. Even if there is a very faint line at **T** (Test), then the test will indicate a normal level. This result means that the Ferritin concentration in blood is normal and that there is no potential iron deficiency.

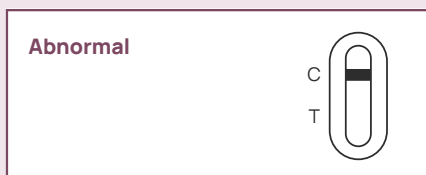

One coloured line appears under the control line (**C**) only. This result means that the ferritin concentration in blood is too low. You should **consult your doctor** because you may have an iron deficiency.

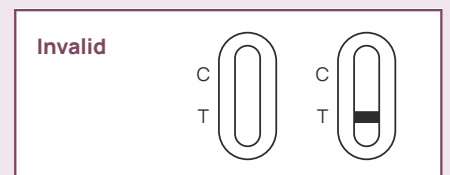

Control line fails to appear. Insufficient specimen volume or incorrect procedural techniques are the most likely reasons for control line failure. Review the procedure and repeat the test with a new test. If the problem persists, discontinue using the test kit immediately and contact your local distributor.

If the result is abnormal – consult with your doctor